

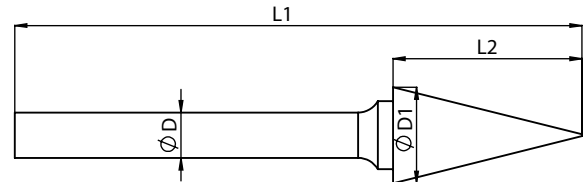

**SM**

**Cone shaped burr**



**3 mm Shank**

Head Diameter	Head length	Overall Length	Shank Dia	Angle Degree	Tool No	Standard cut (Single cut)	Supreme cut (Double cut)	Deluxe cut (Diamond cut)	Aluma Cut	Coarse Cut	CTI Number
ØD1	L2	L1	D			EDP No.	EDP No.	EDP No.	EDP No.	EDP No.	
3	8	38	3	20°	MA1*	FAC0200513	FAC0200514	FAC0200515	–	–	–
6.3	10.5	36.5	3	30°	MA2	FAC0200518	FAC0200519	FAC0200520	–	–	SM-42M
3	11	38	3	14°	MA5*	FAC0200521	FAC0200522	FAC0200523	–	–	SM-43M
3	16	38	3	7°	MA6*	FAC0201255	FAC0201256	FAC0201257	–	–	SM-51M

**6 mm Shank**

6	19	50	6	17°	A1*	FAC0200001	FAC0200002	FAC0200003	FAC0201348	–	SM-2M
6	19	70	6	17°	A1	FAC0200004	FAC0201797	FAC0201793	–	–	SM-2M
9.5	20	70	6	24°	A2	FAC0200012	FAC0200014	FAC0200016	–	–	–
12.7	25	75	6	28°	A3	FAC0200022	FAC0200025	FAC0200027	FAC0201268	–	–
9.5	9.5	60	6	90°	A4	FAC0200036	FAC0200037	FAC0200038	–	–	SK-3M
16	13	63	6	90°	A5	FAC0200039	FAC0200040	FAC0200041	FAC0201353	–	SK-6M
16	16	66	6	60°	A6	FAC0200044	FAC0200046	FAC0200047	–	–	SJ-6M
10	18	68	6	28°	A7	FAC0200050	FAC0200051	FAC0200052	–	–	SM-4M
8	18	68	6	24°	A8	FAC0200053	FAC0200054	FAC0200055	–	–	–
16	25	75	6	31°	A9	FAC0200056	FAC0200058	FAC0200060	–	–	SM-6M
6.2	25	75	6	10°	A10	FAC0200062	FAC0200063	FAC0200064	–	–	SM-3M
9.5	15	65	6	28°	A11	FAC0200065	FAC0200066	FAC0200067	–	–	–
12.7	22	72	6	28°	A12	FAC0200068	FAC0200069	FAC0200070	–	–	SM-5M
6.3	12.7	62	6	22°	A13	FAC0200071	FAC0200072	FAC0200073	–	–	SM-1M

\* indicates full carbide burrs

Note:

- Ask your local representative about our long shank program –Available in 4",5",6",7",8",9",10",11" & 12"
- All sizes available as a special in left hand cut
- Coarse cut burrs available on request



SM

Cone shaped burr

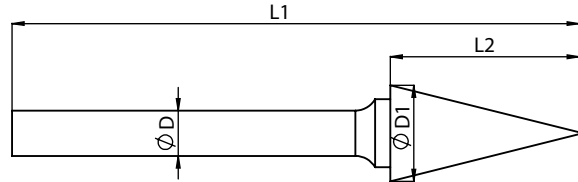

CARBIDE BURRS



8 mm Shank

Head Diameter	Head length	Overall Length	Shank Dia	Angle Degree	Tool No	Standard cut (Single cut)	Supreme cut (Double cut)	Deluxe cut (Diamond cut)	Aluma Cut	Coarse Cut	CTI Number
Ø D1	L2	L1	D			EDP No.	EDP No.	EDP No.	EDP No.	EDP No.	
9.5	20	70	8	24°	A2Z	FAC0201798	FAC0200015	FAC0201799	-	-	-
12.7	25	75	8	28°	A3Z	FAC0201800	FAC0200026	FAC0201801	-	-	-
16	16	66	8	60°	A6Z	FAC0200045	FAC0201803	FAC0201802	-	-	-
16	25	75	8	31°	A9Z	FAC0200057	FAC0200059	FAC0200061	-	-	SM-6M8

1/8 inch Shank

1/8	11/32	1-1/2	1/8	20°	MA1*	FAC0201939	FAC0201941	FAC0201940	-	-	SM-41
1/8	7/16	1-1/2	1/8	14°	MA5*	FAC0201942	FAC0201944	FAC0201943	-	-	SM-42
1/8	5/8	1-1/2	1/8	7°	MA6*	FAC0201945	FAC0201947	FAC0201946	-	-	SM-43

1/4 inch Shank

1/4	1/2	2-1/2	1/4	22°	A13I	FAC0201790	FAC0201792	FAC0201791	-	-	SM-1
1/4	3/4	2-3/4	1/4	17°	A1I	FAC0201794	FAC0201796	FAC0201795	-	-	SM-2
1/4	1.00	3.00	1/4	10°	A10I	FAC0201781	FAC0201783	FAC0201782	-	-	SM-3
3/8	5/8	2-5/8	1/4	28°	A11I	FAC0201784	FAC0201786	FAC0201785	-	-	SM-4
1/2	7/8	2-7/8	1/4	28°	A12I	FAC0201787	FAC0201789	FAC0201788	-	-	SM-5
5/8	1.00	3.00	1/4	31°	A9I	FAC0201804	FAC0201806	FAC0201805	-	-	SM-6

\* indicates full carbide burrs

Note:

- Ask your local representative about our long shank program –Available in 4",5",6",7",8",9",10",11"& 12"
- All sizes available as a special in left hand cut
- Coarse cut burrs available on request